

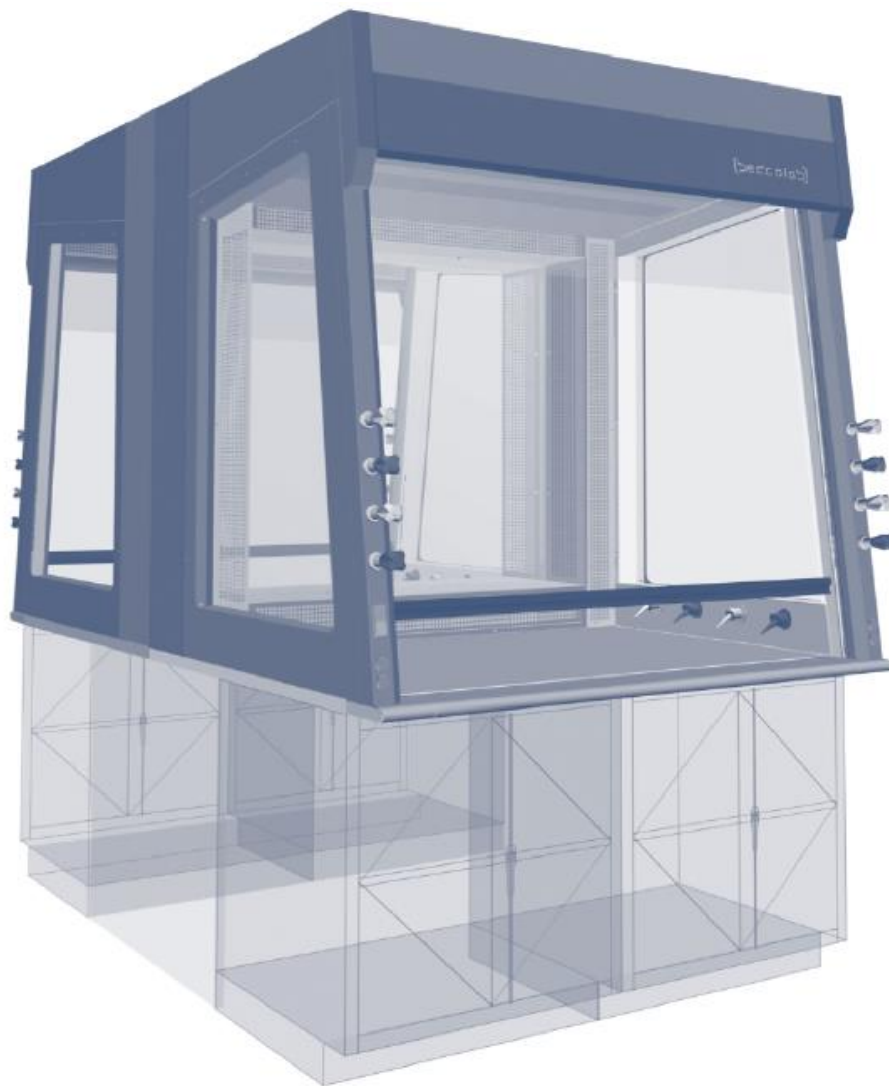

## VISION TEACHING FUME HOODS

### INSTALLATION MANUAL



Designed to maximize teaching process

## PACKING PROCEDURE

---

### Each hood pallet includes:

1. All assembled Fume Hood with electrical and plumbing services
2. Sash weights fixed inside both sides hood side walls
3. Interior back plenum fixed to the hood front
4. Seismic brace (if required) put over the fume hood inside the crate
5. Fume hood Work surface is shipped attached to the hood

### Packing identification:

- 1. Packing tag on the Fume Hood crate indicates:**
  - a. Project name and number
  - b. Fume hood model number
- 2. Fume hood identification sticker located on Fume Hood post indicates:**
  - a. Model number
  - b. Serial number
  - c. Fabrication date
  - d. Certification
- 3. A Maintenance Manual is taped to the interior side wall of every hood**

## INSTALLING BENCH MOUNTED FUME HOODS

---

1. Base cabinets shall first be installed and leveled at the required location.
2. A support angle of the same length as the fume hood base cabinets shall be installed on the wall to properly support the back of the hood.
3. Counter top is already installed under the hood and shall overhang the front of the base cabinet(s) by 25mm (1").
4. Secure work surface to the base cabinets at a minimum of four (4) locations.

5. After placing the fume hood on the base cabinets, you need to follow the following steps:
  - a. The two sash counter weights (one per side) are already hang from the cable system inside the hood:
    - i. You need to open the back side access panels (one per side) by simply lifting up the panels that are fixed in place at three locations (top, middle and bottom).
    - ii. The sash weights are then easily visible inside the open walls.
    - iii. You need to remove the wood blocking supports (one per side) to permit the use of the door.
    - iv. You then make sure the sash door can be use freely without any interferences.
    - v. You need to put back the two access panels into their initial positions by simply hanging them from the three fixing positions.
  - b. The inside plenum located at the inside back of the Fume Hood is factory installed on the hood. There are no procedures necessary regarding the plenum already balanced for an ideal exhaust flow.
  - c. The Seismic bracket is located over the Fume Hood during shipment. Installation of the bracket should be done **after** the hood is installed at his final location on the counter top.
6. You need to lift the fume hood from corner posts only. Do not lift the hood by the front flush sash sill. Set the hood counter top and hood assembly into the right position on the base cabinets.
7. Fume hood counter top should be screw from underneath to the base cabinet.
8. When required and supplied with the hood, you need to install the seismic brackets.
  - a. You first need to screw both angle brackets to the top of the back top structure (on the 2 posts)
  - b. You then need to screw the brackets to the wall making sure it is well secured into the wall blocking.
9. You need to install non-integral cup sink (optional). Set flush with counter top with sealing under and over the cup sink.

**10.** When a corrosive or pump cabinet is required to be vented through the fume hood above, a flexible tube need to be installed from the base cabinet to the hood. You need to bring the tube, which is shipped with the base cabinet, inside the slot in the counter top (inside the plenum) and to the cabinet connection hardware supplied with the cabinet. For ease of installation, be sure to connect the vent kit prior to the mechanical connections.

**11.** Installation of furring panels between the top of the fume hood and ceiling (optional).

**Refer to DETAIL B.**

**12.** The fume hood plumbing, electrical and mechanical connections to the hood services must be done by the proper specialists:

- a. Electrical connections must be done by the electrical contractor to the junction box located over the fume hood. The electrical diagram is located on top of the fluorescent lamp box over the hood.
- b. Plumbing connections for water or gases must be done by the plumbing contractor to the plumbing lines already installed into the hood wall, 6" over the hood top.
- c. Ventilation connection must be done by the mechanical contractor to the round duct stub located over the hood.

**13. Fume hood alarm electrical wiring connection (optional).**

- a. If an alarm is supplied with the hood, it is already connected at the factory to an electrical outlet located over the hood. The electrician shall interconnect this plug with the fan switch in 120 volts only. If fan motor has two (2) positions (high and low), alarm shall be connected to the high position. Connect static pressure tap to the duct as shown.
- b. If the hood is to be exhaust through a VAV system, the installation of the control box, hardware and wiring must be done by the mechanical contractor unless it is requested otherwise.
- c. Despite that the fume hood was tested at the factory before it was shipped, **the electrical, plumbing and mechanical contractors must perform the required testing of all systems before putting any fume hood into operation**

### FUME HOOD INSTALLATION | DETAIL A

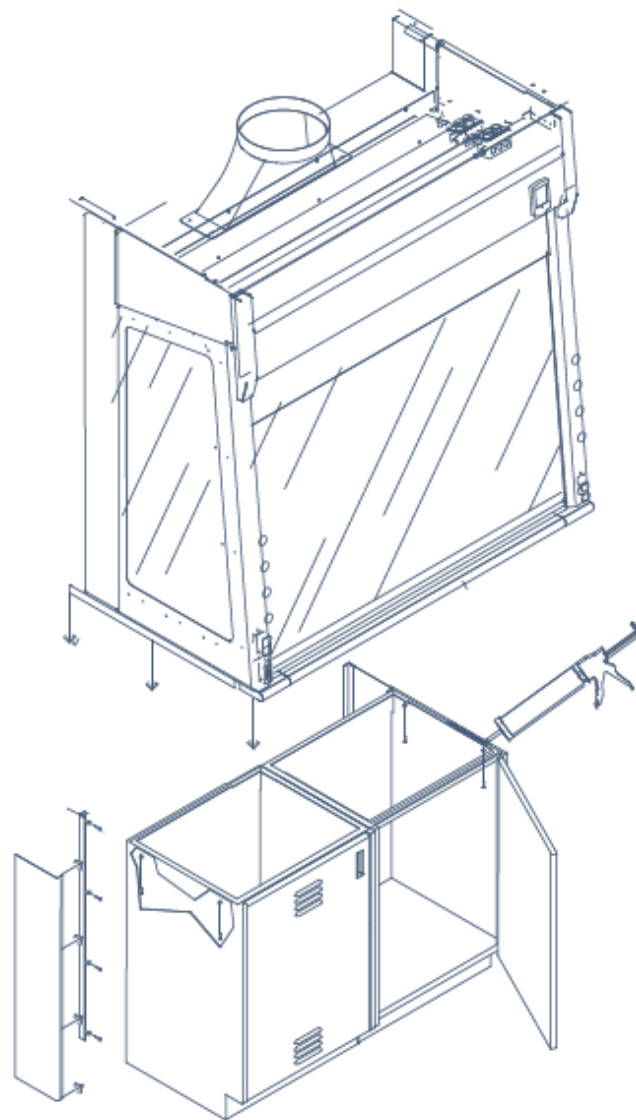

1. **Fillers panels:**  
Find the exact position for the base cabinet(s) and fume hood. Screw in the filler panels angle to the wall and the filler panel to the back of the base cabinet.
2. **Leveling:**  
Adjust all four levelers of all cabinets under the hood to get perfect leveling of the base cabinet.
3. **Fume hood and work surface installation:**  
Apply clear silicone to the outline of the base cabinet, delicately position the hood and work surface assembly on the base cabinets while making sure it is aligned with the cabinet's side and it touches the wall. Increase solidity by using screws from the inside of the base cabinet.
4. **Fume hood installation:**  
**IMPORTANT:** Prior to installation, remove counter weight blockings to release sash
5. **Options, alarm wiring:**  
The alarm is connected to a plug over the hood. The electrician shall connect the plug to the blower switch. If the blower has two different speeds, the alarm wiring will only be connected to the high-speed position. Install sensor to the duck stub with 18" clearance from the collar and connect static pressure tubing to the sensor.

#### 6. **VAV Control:**

If a VAV Control unit is installed on the hood, connections shall be done by a technician from the control company.

#### 7. **Options, cup sink installation:**

Insert cup sink into work surface dedicated hole, seal cup sink outline.

Option, Ventilated base cabinet exhaust pipe connection to the fume hood: Connect flexible pipe to exhaust hole positioned under the counter top. Allow flexible pipe to connect to the base cabinet exhaust hole.

#### 8. **Interior sealing:**

You need to seal the interior hood perimeter between the walls and the counter top with clear silicone

## INSTALLING FUME HOOD FURRING PANELS | DETAIL B

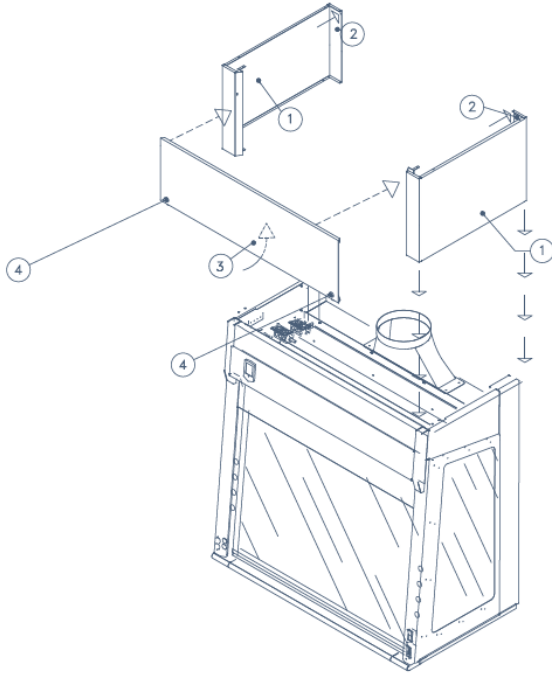

1. YOU FIRST NEED TO INSTALL SIDE PANELS OVER THE FUME HOOD WALLS BY SECURING THE PANELS TO THE TOP HOOD STRUCTURE AND THE WALL.
2. YOU THEN NEED TO INSTALL THE FRONT PANEL BY INSERTING THE PANEL INTO THE SIDE PANEL FRONT SLOTS AND LOCKING THE STUB INTO CLOSE POSITION.

## INSTALLING FUME HOOD SERVICE FITTINGS

### Electrical

The fume hood light, light switch and two (2) receptacles shall be pre-wired to a junction box on top of the fume hood superstructure. A qualified electrician shall make connections to the power supply. An electrical diagram of the connections is located over the fluorescent lamp box over the hood.

### Plumbing

Plumbing connections for water or gases must be done by the plumbing contractor to the plumbing lines already installed into the hood wall, 6" over the hood top.

### Exhaust

Ventilation connection must be done by the mechanical contractor to the round duct stub located over the hood.

Special care must be done by the trade subcontractors to make sure that any of the electrical, plumbing and ventilation connections are not in interference with any of the weight sash system components located over the hood.

### LIGHT REPLACEMENT

---

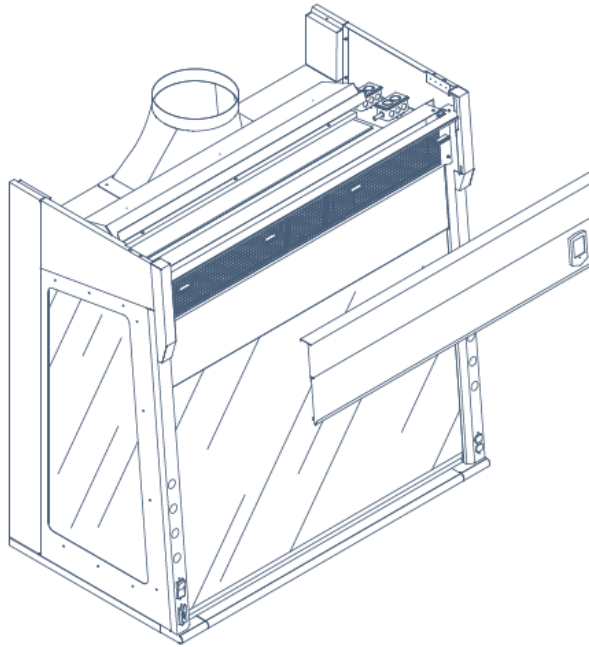

1. REMOVE THE FRONT PANEL OVER THE HOOD.
2. TILT THE LIGHTING BOX TOWARDS THE REAR OF THE FUME HOOD. (OPEN)
3. REPLACE THE DEFECTIVE LED LIGHT.
4. RETURN LIGHTING BOX TO ORIGINAL POSITION. (CLOSED)
5. REPLACE FRONT PANEL.

## TECHNICAL SERVICES

---

If you require any additional information, please contact the following addresses for prompt responses.

**Supplier and distributor:**

Bedcolab Ltd  
2305 Francis-Hughes Avenue  
Laval, Quebec, Canada  
H7S 1N5  
Telephone: 514-384-2820 or 1-800-461-6414  
Fax: 514-384-9292  
Web site: [www.bedcolab.com](http://www.bedcolab.com)  
Email address: [information@bedcolab.com](mailto:information@bedcolab.com)

**Manufacturer:**

Bedco, division of Gerodon Canada Inc.  
2305 Francis-Hughes Avenue  
Laval, Quebec, Canada  
H7S 1N5  
Telephone: 514-384-2820 or 1-800-461-6414  
Fax: 514-384-9292